

Spring preload

ECA13590

NOTICE

Never go beyond the maximum or minimum adjustment positions.

1. Adjust:
 - Spring preload

TIP

Adjust the spring preload with the special wrench and extension bar included in the owner's tool kit.

- a. Turn the adjusting ring "1" in direction "a" or "b".
- b. Align the desired position on the adjusting ring with the position indicator "2".

Direction "a"

Spring preload is increased (suspension is harder).

Direction "b"

Spring preload is decreased (suspension is softer).



Adjusting positions

Adjustment value (Soft)

1

Adjustment value (STD)

3

Adjustment value (Hard)

5

TIP

The adjustment value is the adjusting ring position number.

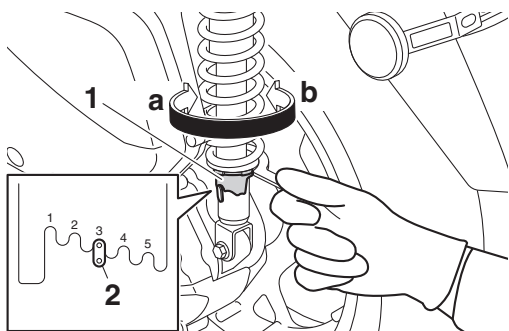

EAS30656

CHECKING THE ENGINE OIL LEVEL

1. Stand the vehicle on a level surface.

TIP

- Place the vehicle on the centerstand.
- Make sure the vehicle is upright.

2. Start the engine, warm it up for several minutes, and then turn it off.
3. Check:
 - Engine oil level

The engine oil level should be between the minimum level mark "a" and maximum level mark "b".

Below the minimum level mark → Add the recommended engine oil to the proper level.

TIP

Before checking the engine oil level, wait a few minutes until the oil has settled.

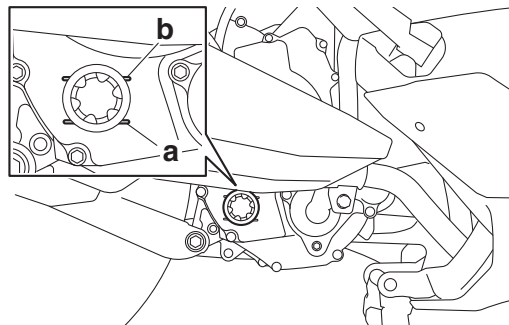

Recommended brand

YAMALUBE

SAE viscosity grades

10W-40

Recommended engine oil grade

API service SG type or higher,

JASO standard MA or MB

ECA13370

NOTICE

Do not allow foreign materials to enter the crankcase.

4. Start the engine, warm it up for several minutes, and then turn it off.
5. Check the engine oil level again.

TIP

Before checking the engine oil level, wait a few minutes until the oil has settled.

EAS30657

CHANGING THE ENGINE OIL

1. Start the engine, warm it up for several minutes, and then turn it off.
2. Place a container under the engine oil drain bolt.
3. Remove:
 - Engine oil filler cap "1" (along with the O-ring "2")
 - Engine oil drain bolt "3" (along with the gasket "4")

PERIODIC MAINTENANCE

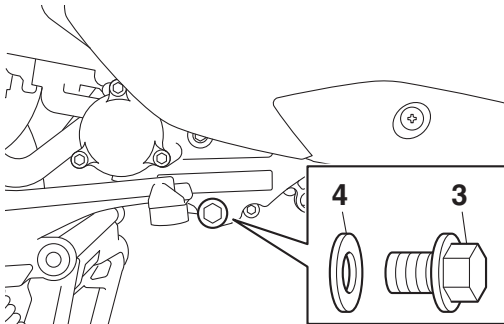
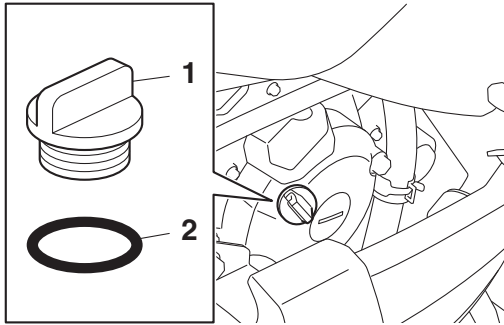

4. Drain:
- Engine oil (completely from the crankcase)
5. If the oil strainer is also to be cleaned, perform the following procedure.
- Remove the oil filter element cover "1" and oil filter element "2".
 - Install a new O-ring "3" **New**.

TIP

Lubricate the O-ring with lithium-soap-based grease.

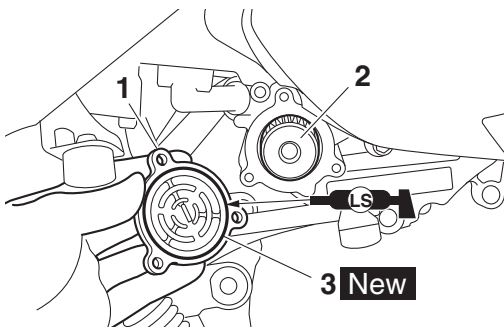

- Install the oil filter element and oil filter element cover.



Oil filter element cover bolt
10 N·m (1.0 kgf·m, 7.4 lb·ft)

6. Install:
- Engine oil drain bolt (along with the gasket **New**)



Engine oil drain bolt
20 N·m (2.0 kgf·m, 15 lb·ft)

7. Fill:
- Crankcase (with the specified amount of the recommended engine oil)



Engine oil quantity
Oil change
1.50 L (1.59 US qt, 1.32 Imp.qt)
With oil filter removal
1.60 L (1.69 US qt, 1.41 Imp.qt)
Quantity (disassembled)
1.70 L (1.80 US qt, 1.50 Imp.qt)

8. Install:
- Engine oil filler cap (along with the O-ring **New**)
9. Start the engine, warm it up for several minutes, and then turn it off.
10. Check:
- Engine (for engine oil leaks)
11. Check:
- Engine oil level Refer to "CHECKING THE ENGINE OIL LEVEL" on page 3-18.
12. Remove:
- Storage box Refer to "GENERAL CHASSIS (4)" on page 4-10.
13. Check:
- Engine oil pressure
 - Slightly loosen the oil check bolt "1".

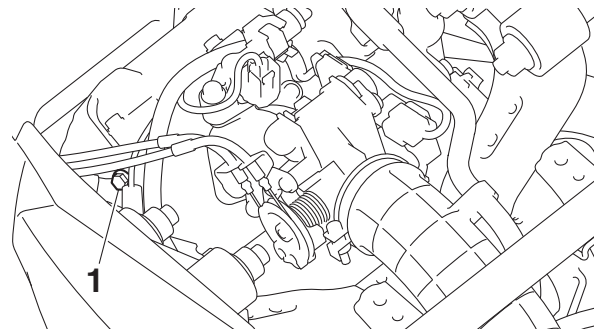

- Start the engine and keep it idling until engine oil starts to seep from the oil check bolt. If no engine oil comes out after one minute, turn the engine off so that it will not seize.
- Check the engine oil passages and the oil pump for damage or leakage. Refer to "OIL PUMP" on page 5-56.

PERIODIC MAINTENANCE

- d. Start the engine after solving the problem(s) and check the engine oil pressure again.
- e. Tighten the oil check bolt to specification.

	Engine oil check bolt 7 N·m (0.7 kgf·m, 5.2 lb·ft)
---	--

EAS31187

CHANGING THE FINAL TRANSMISSION OIL

1. Stand the vehicle on a level surface.

TIP

- Place the vehicle on the centerstand.
- Make sure the vehicle is upright.

2. Start the engine, warm it up for several minutes, and then turn it off.

3. Place a container under the final transmission.

4. Remove:

- Final transmission oil filler cap “1” (along with the O-ring “2”)
 - Final transmission oil drain bolt “3” (along with the copper washer “4”)
- Completely drain the final transmission oil.

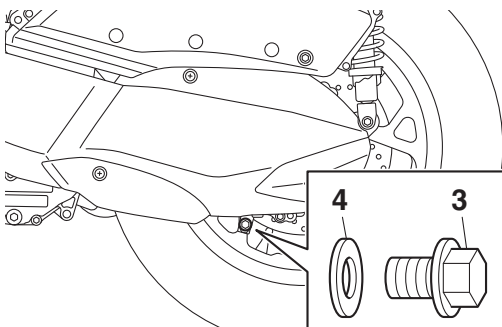
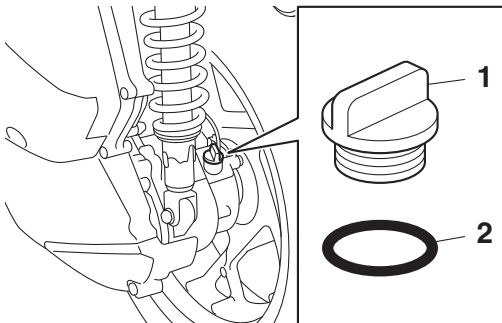

5. Install:

- Final transmission oil drain bolt (along with the copper washer **New**)

	Final transmission oil drain bolt 20 N·m (2.0 kgf·m, 15 lb·ft)
---	--

6. Fill:

- Final transmission oil (with the specified amount of the recommended final transmission oil)

	Final transmission oil
	Type Motor oil SAE 10W-30 type SE or higher or Gear oil SAE 85W GL-3
	Quantity (disassembled) 0.23 L (0.24 US qt, 0.20 Imp.qt)
	Quantity 0.20 L (0.21 US qt, 0.18 Imp.qt)

7. Install:

- Final transmission oil filler cap (along with the O-ring **New**)

TIP

Lubricate the O-ring with lithium-soap-based grease.

8. Start the engine, warm it up for several minutes, and then turn it off.

9. Check:

- Final transmission oil leakage

EAS30811

CHECKING THE COOLANT LEVEL

1. Stand the vehicle on a level surface.

TIP

- Place the vehicle on the centerstand.
- Make sure the vehicle is upright.

2. Check:

- Coolant level

The coolant level should be between the minimum level mark “a” and maximum level mark “b”.

Below the minimum level mark → Add the recommended coolant to the proper level.

